

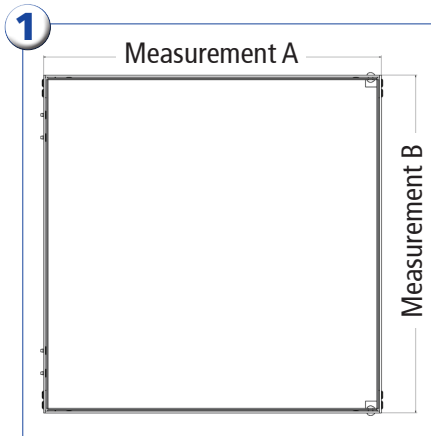

Monteringsvejledning

Inspektionslem til forfra montage - s1

Mounting in Plasterboard Ceiling/ Wall



Measure the outer dimensions of the panel.

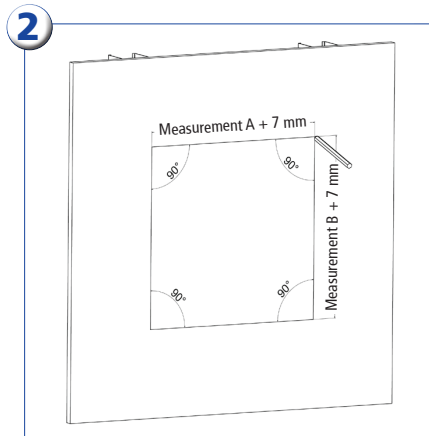

Mark the panel measurements.

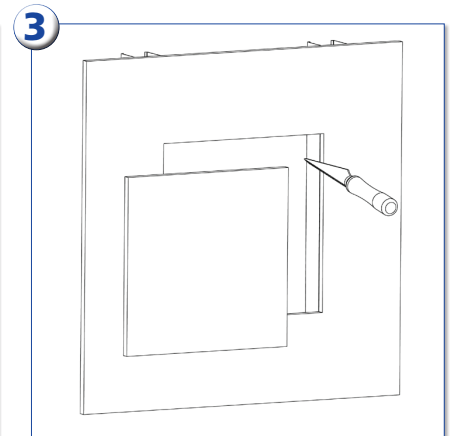

Cut out the hole for the panel.

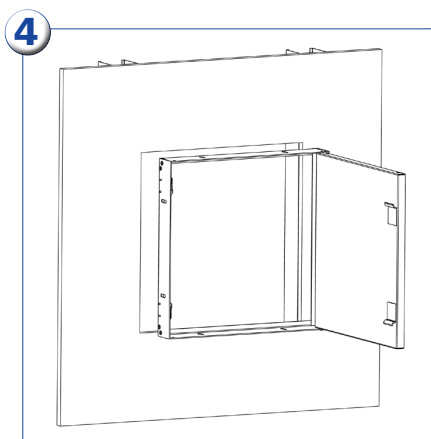

Fit the inspection panel.

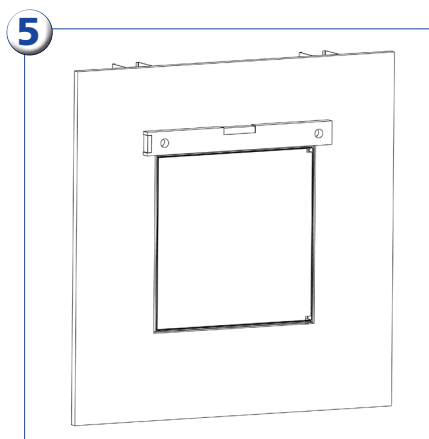

Correct the alignment.

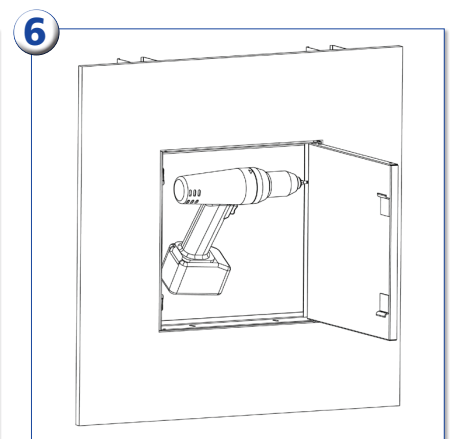

Attach the frame.

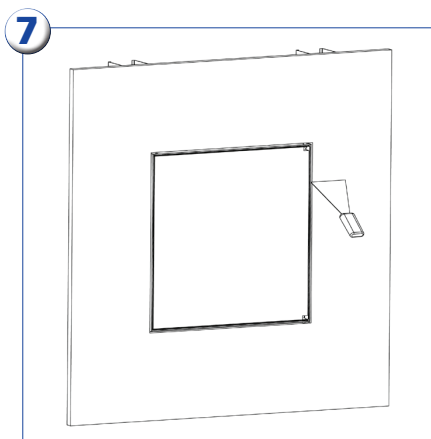

Fill and smooth the joints.

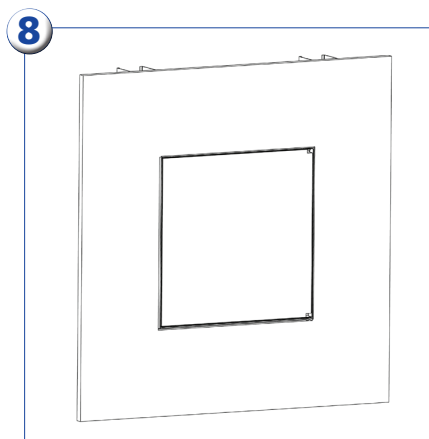

Attach the panel door- Finished!





Monteringsvejledning Inspektionslem til forfra montage - s2

Mounting in Wall and Ceiling systems without structural requirements

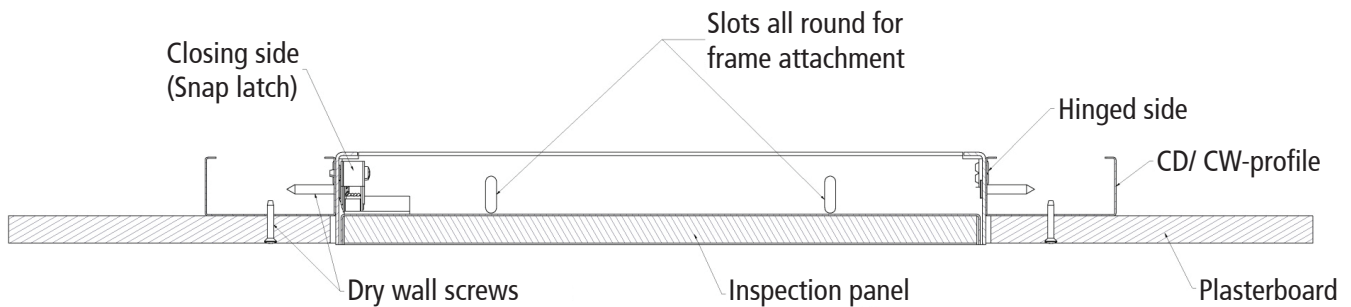

- ❶ Cut the hole in the wall or ceiling 5 – 10 mm larger than the nominal size of the inspection panel.
Attention: the hole must have accurate right angles!
The profile spacing must correspond exactly to the mounting dimensions of the inspection panel.
Tip: for easier mounting, the CW/ CD-profiles for fixing the panel door can be screwed on to the frame beforehand.
- ❷ Screw the hinged side to the CW/ CD-profile.
- ❸ Align the closing side at a right angle to the hinged side and screw it to the CW/ CD-profile.
- ❹ Close the inspection panel door and check if it functions correctly (does the door close correctly, is the gap at the side of the panel door even?).
- ❺ Attach the side components to the CW/ CD-profile by screwing the dry wall screws through the slots.
- ❻ Recheck the panel door function!
- ❼ You can now apply filler between the inspection panel and surrounding joints.
Attention: Make sure no filler or paint gets into the gap between the door panel and installation frame!
This prevents the door from opening!

(Wall mounting is carried out according to the same principle but with use of the respective CW-profiles for attachment!)

